

**CCS6-600** weight = 0,148 kg  
Conical coupler

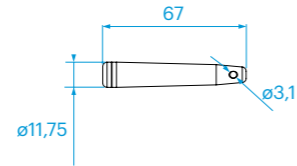

**CCS6-603** weight = 0,042 kg  
Spigot  
CCS6-603RF (stainless steel) To be used with CCS6-605 safety R-spring

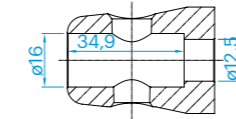

**CCS6-652S**  
Male coupler 600 half With 12,5 mm hole for bolts M12  
BM - M12 x 028 - 652. Bolt M12 x 028 bolt for CCS6 - 652S

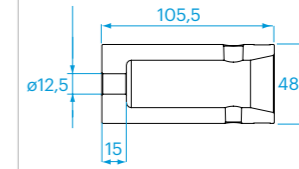

**CCS6-653** weight = 0,360 kg  
Female conical coupler With 12,5 mm hole for bolts M12

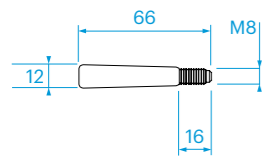

**CCS6-604** weight = 0,040 kg  
Spigot with thread M8 To be used with selflocking nut  
CCS6 - 604RF (stainless steel) BM-M8-SN

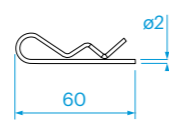

**CCS6-605** weight = 0,003 kg  
Safety R-spring

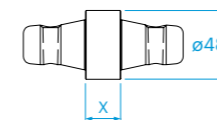

**CCS6-S02 through CCS6-S50** weight = 0,187 kg - 0,404 kg  
Spacers X = 2 mm to 50 mm in steps of 5 mm

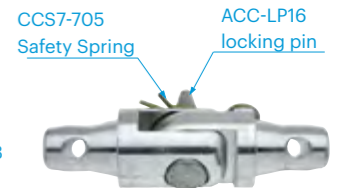
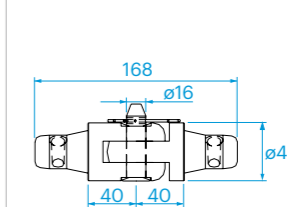

**CCS6-H** weight = 0,590 kg  
Hinge for MPT Tower or ST Tower, 4 hinges per tower needed. See BlackBook "Technical Matters" for the use of hinges in different setups.



**CCS6-607** weight = 0,088 kg  
Spigot with Length To be used with CCS6 - 605 safety R-spring

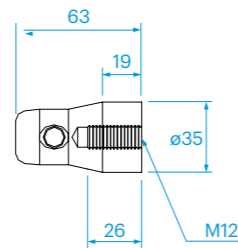

**CCS6-602** weight = 0,116 kg  
Offset half conical coupler Offset 19 mm, thread M12

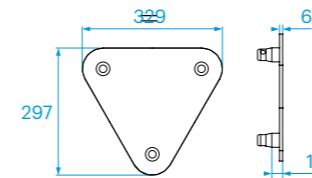

**BASE 30D** weight = 1,160 kg  
Baseplate for X+H30D truss incl:  
CCS6-649 Conical half coupler  
BM-M12X020-IB-CS Bot M12X20mm countersunk

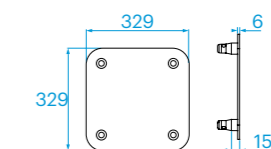

**BASE 30V** weight = 1,860 kg  
Baseplate for X+H30D truss incl:  
CCS6-649 Conical half coupler  
BM-M12X020-IB-CS Bot M12X20mm countersunk

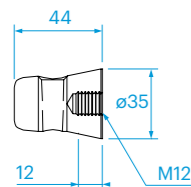

**CCS6-650** weight = 0,069 kg  
Half conical coupler Offset 0 mm, thread M12

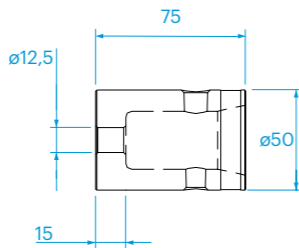

**CCS6-651** weight = 0,280 kg  
Female conical coupler With 12,5 mm hole for bolts M12

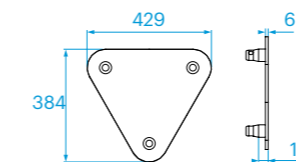

**BASE 40D** weight = 2,700 kg  
Baseplate for H40D truss incl:  
CCS6-649 Conical half coupler  
BM-M12X020-IB-CS Bot M12X20mm countersunk

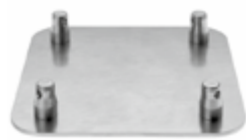
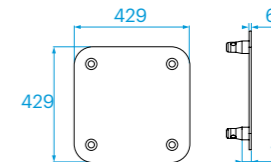

**BASE 40V** weight = 2,820 kg  
Baseplate for H40D truss incl:  
CCS6-649 Conical half coupler  
BM-M12X020-IB-CS Bot M12X20mm countersunk

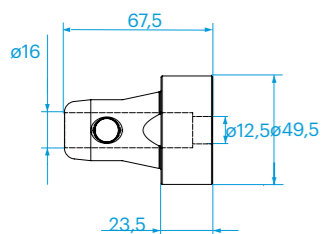

**CCS6-652-23,5** weight = 0,469 kg  
Half conical coupler Offset 23,5 mm, 12,5 mm hole  
To be used with a M12 Hexagon head

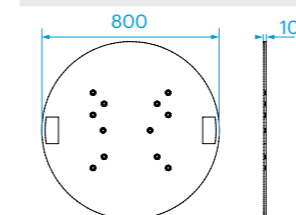

**BASE-30-40-RS-BC** weight = 38 kg  
Base steel 30-40 series 800x10mm round black coated;  
**BASE-30-40-RS-G** - Galvanized  
CCS6-649 Conical half coupler  
BM-M12X020-IB-CS Bot M12X20mm countersunk

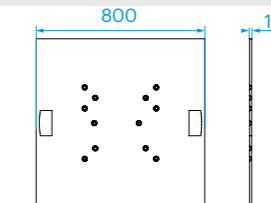

**BASE-30-40-SS-BC** weight = 49 kg  
Base steel 30-40 series 800x10mm round black coated;  
**BASE-30-40-SS-G** - Galvanized  
CCS6-649 Conical half coupler  
BM-M12X020-IB-CS Bot M12X20mm countersunk